

**AKČNÍ CENA**

**již od 94,- Kč**

Ize použít do většiny standardních držáků

\* AKCE PLATÍ DO 30.8.2020 i na objednávky neskladového množství!

\* Pro bližší informace, nebo technické poradenství kontaktujte obchodní oddělení.

## 螺纹刀片命名规则 Threading Inserts Identification System

16 E R 1.50 ISO – TC

①
②
③
④
⑤
⑥

①刀片尺寸 Insert Size	
代号	IC(mm)
11	6.35
16	9.525
22	12.7

②螺纹类别 Thread Style
E=外螺纹
I=内螺纹
□=内外螺纹

③刀片方向 Hand of Insert
R=右手刀
L=左手刀
□=左右手刀

④螺距 Pitch		
全牙型螺距范围		
mm	TPI	
0.35–5.0	72–5	
范围牙型螺距范围		
代号	mm	TPI
A	0.5–1.5	48–16
AG	0.5–3.0	48–8
G	1.75–3.0	14–8
N	3.5–5.0	7–5

⑤螺纹标准 Thread Standard
60=60° 通用型螺纹
55=55° 通用型螺纹
ISO=公制ISO标准型螺纹
UN=美制统一标准型螺纹
W=英制惠氏螺纹
NPT=美制标准锥管螺纹
BSPT=英制标准锥管螺纹
ACME=美制梯形螺纹
STACME=美制短牙梯形螺纹
ABUT=美制锯齿形螺纹
API=美制石油工业螺纹
UNJ=美制航空航天螺纹

⑥附加信息 Additional Information
用来定义牙数或槽型等

## 公制 60° ● Metric 60°

### ▶ 外螺纹 ● External

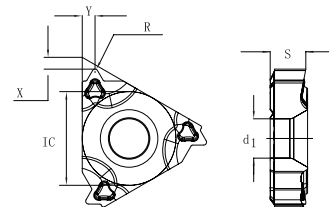

订货号 Ordering Code	螺距 Pitch (mm)	尺寸 Dimensions(mm)						库存 Availability	
		X	Y	R	IC	S	d1	GM3225	
	16 ER1.00ISO-TC	1.00	0.8	0.7	0.14	9.525	3.47	4	●
	16 ER1.25ISO-TC	1.25	0.8	0.9	0.18	9.525	3.47	4	●
	16 ER1.50ISO-TC	1.50	0.8	1.0	0.22	9.525	3.47	4	●
	16 ER1.75ISO-TC	1.75	1.2	1.2	0.25	9.525	3.47	4	●
	16 ER2.00ISO-TC	2.00	1.2	1.3	0.29	9.525	3.47	4	●
	16 ER2.50ISO-TC	2.50	1.2	1.5	0.36	9.525	3.47	4	●
	16 ER3.00ISO-TC	3.00	1.2	1.5	0.43	9.525	3.47	4	●

●标准库存 Stock ○需预定 Available upon Order

### ▶ 内螺纹 ● Internal

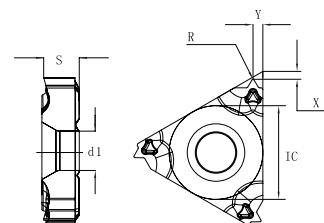



订货号 Ordering Code	螺距 Pitch (mm)	尺寸 Dimensions(mm)						库存 Availability	
		X	Y	R	IC	S	d1	GM3225	
	16 IR1.00ISO-TC	1.00	0.8	0.7	0.07	9.525	3.47	4	●
	16 IR1.25ISO-TC	1.25	0.8	0.9	0.09	9.525	3.47	4	●
	16 IR1.50ISO-TC	1.50	0.8	1.0	0.11	9.525	3.47	4	●
	16 IR1.75ISO-TC	1.75	1.2	1.2	0.13	9.525	3.47	4	●
	16 IR2.00ISO-TC	2.00	1.2	1.3	0.15	9.525	3.47	4	●
	16 IR2.50ISO-TC	2.50	1.2	1.5	0.18	9.525	3.47	4	●
	16 IR3.00ISO-TC	3.00	1.2	1.5	0.22	9.525	3.47	4	●

●标准库存 Stock ○需预定 Available upon Order

## BSPT 55°

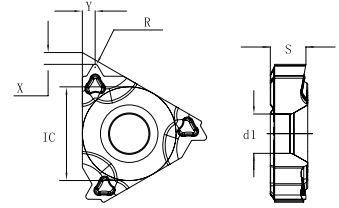
▶ 外螺纹 • External



订货号 Ordering Code	螺距 Pitch (TPI)	尺寸 Dimensions(mm)						库存 Availability	
		X	Y	R	IC	S	d1	GM3225	
	16 ER28BSPT-TC	28	0.7	0.8	0.11	9.525	3.47	4	●
	16 ER19BSPT-TC	29	0.8	1.0	0.17	9.525	3.47	4	●
	16 ER14BSPT-TC	14	1.2	1.5	0.24	9.525	3.47	4	●
	16 ER11BSPT-TC	11	1.2	1.5	0.30	9.525	3.47	4	●

●标准库存 Stock ○需预定 Available upon Order

▶ 内螺纹 • Internal

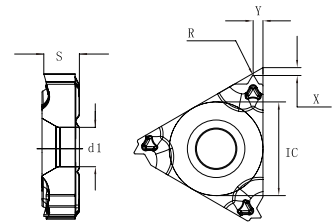



订货号 Ordering Code	螺距 Pitch (TPI)	尺寸 Dimensions(mm)						库存 Availability	
		X	Y	R	IC	S	d1	GM3225	
	16 IR28BSPT-TC	28	0.7	0.8	0.11	9.525	3.47	4	●
	16 IR19BSPT-TC	19	0.8	1.0	0.17	9.525	3.47	4	●
	16 IR14BSPT-TC	14	1.2	1.5	0.24	9.525	3.47	4	●
	16 IR11BSPT-TC	11	1.2	1.5	0.30	9.525	3.47	4	●

●标准库存 Stock ○需预定 Available upon Order

## 惠氏55° ● Whitworth 55°

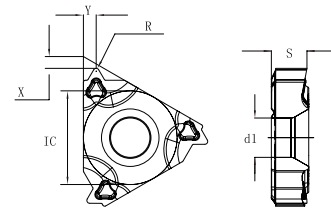
### ▶ 外螺纹 ● External



订货号 Ordering Code	螺距 Pitch (TPI)	尺寸 Dimensions(mm)						库存 Availability	
		X	Y	R	IC	S	d1	GM3225	
	16 ER19W-TC	19	0.8	1.0	0.17	9.525	3.47	4	●
	16 ER14W-TC	14	1.2	1.5	0.24	9.525	3.47	4	●
	16 ER11W-TC	11	1.2	1.5	0.30	9.525	3.47	4	●

● 标准库存 Stock ○ 需预定 Available upon Order

### ▶ 内螺纹 ● Internal

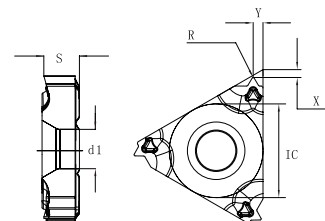

订货号 Ordering Code	螺距 Pitch (TPI)	尺寸 Dimensions(mm)						库存 Availability	
		X	Y	R	IC	S	d1	GM3225	
	16 IR19W-TC	19	0.8	1.0	0.17	9.525	3.47	4	●
	16 IR14W-TC	14	1.2	1.5	0.24	9.525	3.47	4	●
	16 IR11W-TC	11	1.2	1.5	0.30	9.525	3.47	4	●

● 标准库存 Stock ○ 需预定 Available upon Order

螺纹刀

Threading Inserts

加工案例

Case Studies

Case 1

工件材质 Workpiece Material	C45
加工方式 Processing Way	螺纹加工、湿切 Threading, Wet
切削参数 Cutting Parameters	Vc=110m/min
使用刀片 Inserts	16ER1.50ISO-TC GM3225

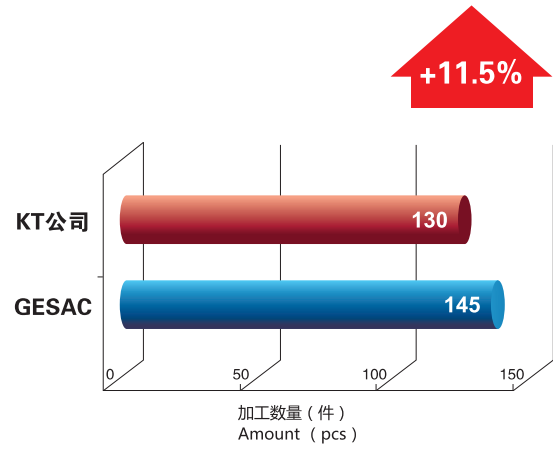
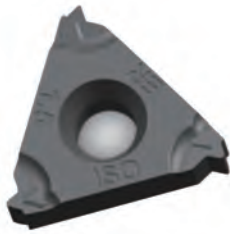

Case 2

工件材质 Workpiece Material	316
加工方式 Processing Way	螺纹加工、湿切 Threading, Wet
切削参数 Cutting Parameters	Vc=150m/min
使用刀片 Inserts	16IR11BSPT-TC GM3225

